

WARNING

READ ALL SAFETY INSTRUCTIONS BEFORE USE.

To avoid electric shock, special care should be taken since water is employed in the use of aquarium equipment. For each of the following situations, do not attempt to repair yourself. Return the appliance to an authorized service facility for service or discard the appliance.

Carefully examine the appliance after installation. It should not be plugged in if there is water on parts not intended to be wet.

Do not operate any appliance if it has a damaged cord or plug, or if it is malfunctioning or if it is dropped or damaged in any manner.

To avoid the possibility of the appliance plug or receptacle getting wet, position aquarium to one side of a wall mounted receptacle to prevent water from dripping onto the receptacle plug. A "Drip Loop" should be arranged by the user for EACH cord connecting an aquarium appliance to a receptacle. The "Drip Loop" is that part of the cord below the level of the receptacle or the connector if an extension cord is used. This "Drip Loop" prevents water travelling along the cord and coming in contact with the receptacle. If the plug or the receptacle do get wet DO NOT unplug the cord. Disconnect the fuse to the circuit breaker that supplies power to the appliance. Then unplug and examine for the presence of water in the receptacle.

Close supervision is necessary when any appliance is used by or near children.

Always unplug an appliance from the outlet when not in use, before putting on or taking off parts, and before cleaning. Never yank the cord to pull plug from outlet. Grasp the plug and pull to disconnect.

Do not use an appliance for other than intended use. The use of attachments not recommended or sold by the appliance manufacturer may cause an unsafe condition.

Do not install or store the appliance where it will be exposed to the weather or to temperatures below freezing.

Make sure an appliance mounted on a tank is securely installed before operating it.

Read and observe all the important notices on the appliance.

This appliance has a polarized plug (one blade is wider than the other). As a safety feature, the plug will fit in a polarized outlet only one way. If the plug does not fit fully in the outlet, reverse the plug. If it still does not fit, contact a qualified electrician. Never use with an extension cord unless plug can be fully inserted. Do not attempt to defeat this safety feature.

If an extension cord is necessary, a cord with a proper rating should be used.

How to Assemble

1. Insert the Inner Chamber inside the Outer Chamber
2. Attach the Clear Bracket to the Outer Chamber
3. Attach the Pump to the bottom of the Outer Chamber

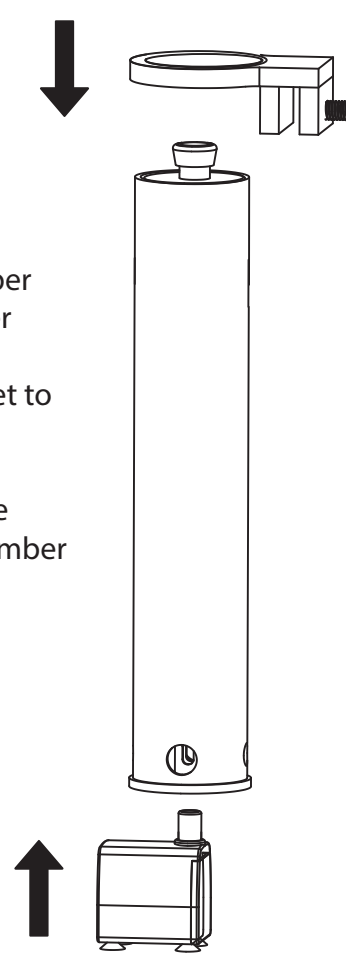

How to Fill

1. Remove Inner Chamber from Outer Chamber
2. Remove Rubber Cap from Inner Chamber
3. Carefully pour in media
4. Replace Rubber Cap
5. Reinsert the Inner Chamber back into the Outer Chamber

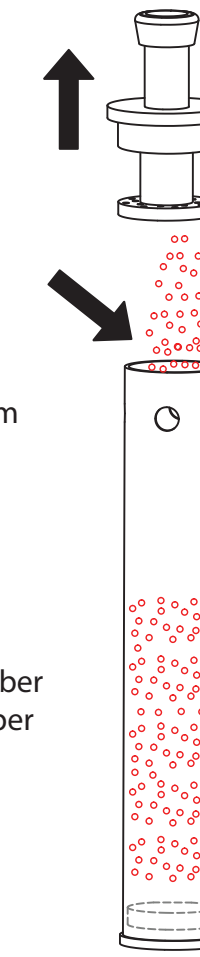

How to Install

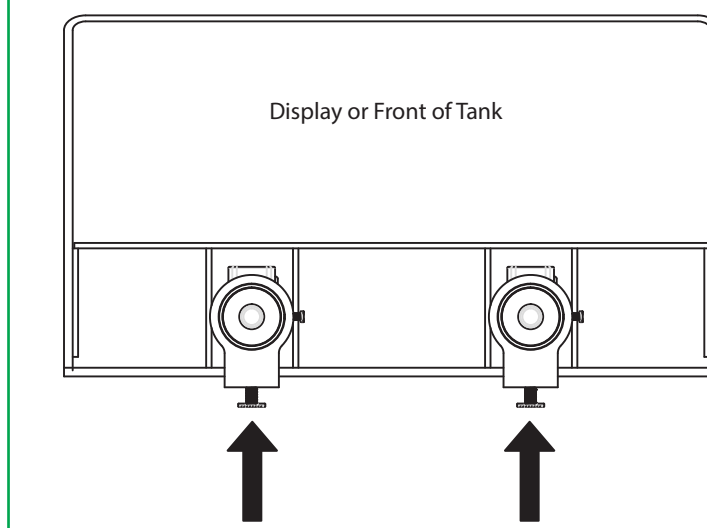

Using the clear mounting bracket attach your MiniMax Pro to the Skimmer/ Reactor Chambers in the back of your aquarium.

The MiniMax Pro is designed to be submerged in water and should not be used as a hang-on type reactor out of water.

How to Use

1. Make sure your Inner Chamber is inline with the Flow Channel on the bottom of the reactor
2. Double Check to ensure pump is attached
3. Plug In the MiniMax Pro and adjust to desired flow rate using the Flow Adjusting Knob attached to the cap

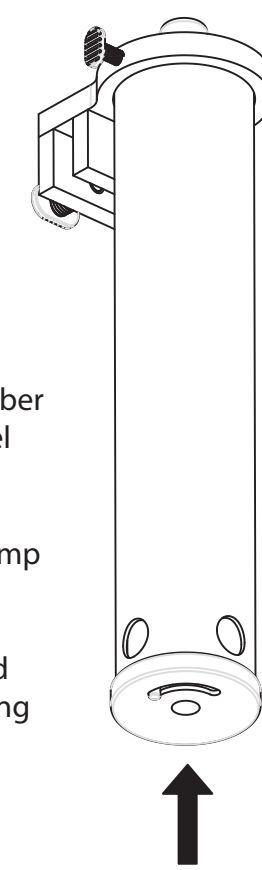

The MiniMax Pro Reactors incorporate a responsive water flow adjusting knob.

Since, different media require different flow rates, this feature allows min to max flow settings with a simple turn of the knob.

7305 - MiniMax Pro Desktop Reactor

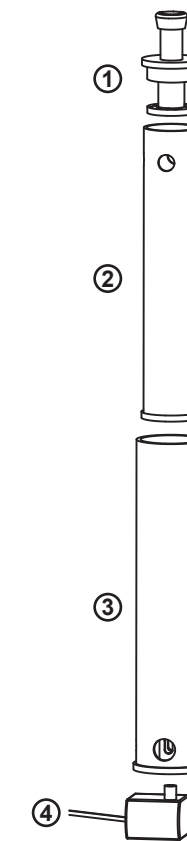

Fits all NUVO DeskTop AIO Aquariums
Max Volume Capacity - 150ml
Pump Wattage - 24V/5W
Pump Flow Rate - 130 GPH
Dims - 2.3" x 3.25" x 13"

① MiniMax Pro DeskTop Cap	730501
② MiniMax Pro DeskTop Inner Chamber	730502
③ MiniMax Pro DeskTop Outer Chamber	730503
④ MiniMax Pro DeskTop Pump	730101

7306 - MiniMax Pro MidSize Reactor

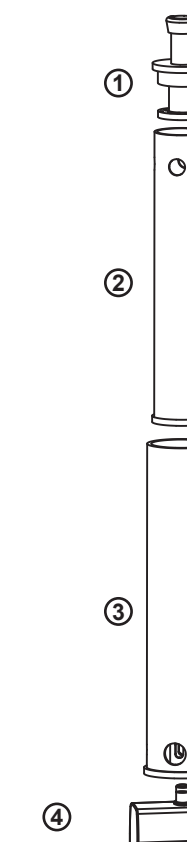

Fits all NUVO MidSize AIO Aquariums
Max Volume Capacity - 300ml
Pump Wattage - 24V/5W
Pump Flow Rate - 130 GPH
Dims - 3.13" x 2.69" x 15"

① MiniMax Pro MidSize Cap	730601
② MiniMax Pro MidSize Inner Chamber	730602
③ MiniMax Pro MidSize Outer Chamber	730603
④ MiniMax Pro MidSize Pump	020001

www.innovative-aquarium.com

7307 - MiniMax Pro FullSize Reactor

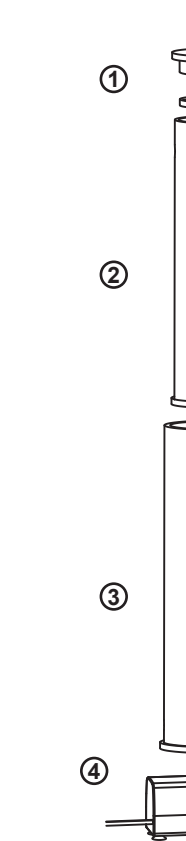

Fits all NUVO FullSize Aquariums
Max Volume Capacity - 1 Liter
Pump Wattage - 24V/5W
Pump Flow Rate - 130 GPH
Dims - 4.8" x 5.31" x 17.13"

① MiniMax Pro FullSize Cap	730701
② MiniMax Pro FullSize Inner Chamber	730702
③ MiniMax Pro FullSize Outer Chamber	730703
④ MiniMax Pro FullSize Pump	020004

7308 - MiniMax Pro Sump Reactor

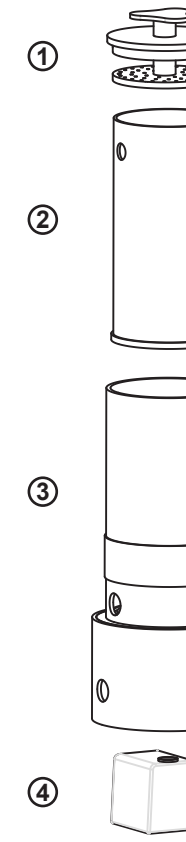

For Sump Aquariums
Max Volume Capacity - 380ml
Pump Wattage - 24V/5W
Pump Flow Rate - 130 GPH
Dims - 4.33" x 3.54" x 9.64"

MiniMax Pro Sump Cap	730801
MiniMax Pro Sump Inner Chamber	730802
MiniMax Pro Sump Outer Chamber	730803
MiniMax Pro Sump Pump	020001